

Installation Instructions

Trim-Trail 5 station circuit

incl. Post shoes

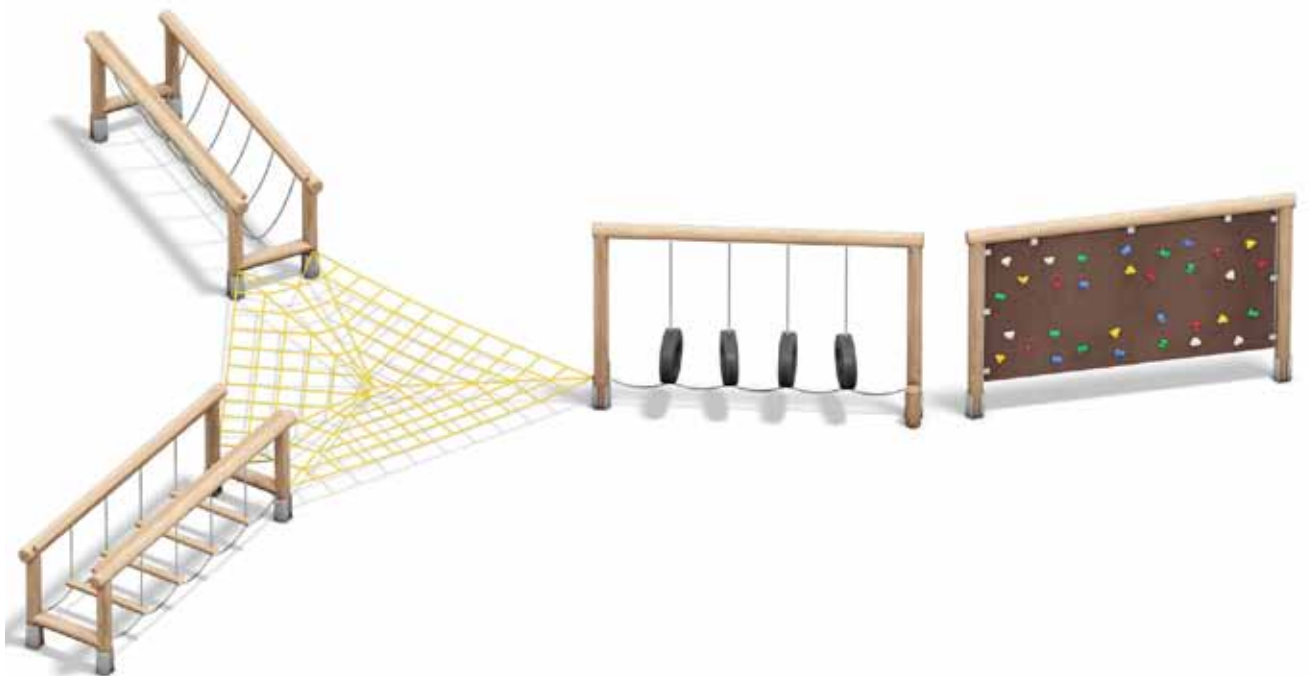

The picture can deviate from product

Installation Instructions

Trim-Trail 5 station circuit	
Artikel-Nr.:	12.05.150 Trim-Trail 5 station circuit
Dimension:	Depends on arrangement
Safety Area:	Depends on arrangement plus 1,50 m
Ground:	Free Fall Height: max. 1,92 m
Foundation:	20 of 50/50/60cm = 3,00 m ³ concrete (C25/30)
Age Range:	4 years upwards
Scope of Delivery	1 Log Balance 1 Chain-Loop-Bridge 1 Monkey-Swing 1 Freeclimbing-Wall 1 Net-Connection
Weight:	3,16 m x 0,90 m x 0,50 m 256kg
Notes:	

ATTENTION:

Read installation instructions through before commencing erection of unit. Do NOT install until the unit is completely assembled

Ensure that the concrete foundation is sufficiently hardened before first use.

Ensure all installation aids are removed before using!

Name:	KP								
Date:	27.02.12								

Installation Instructions

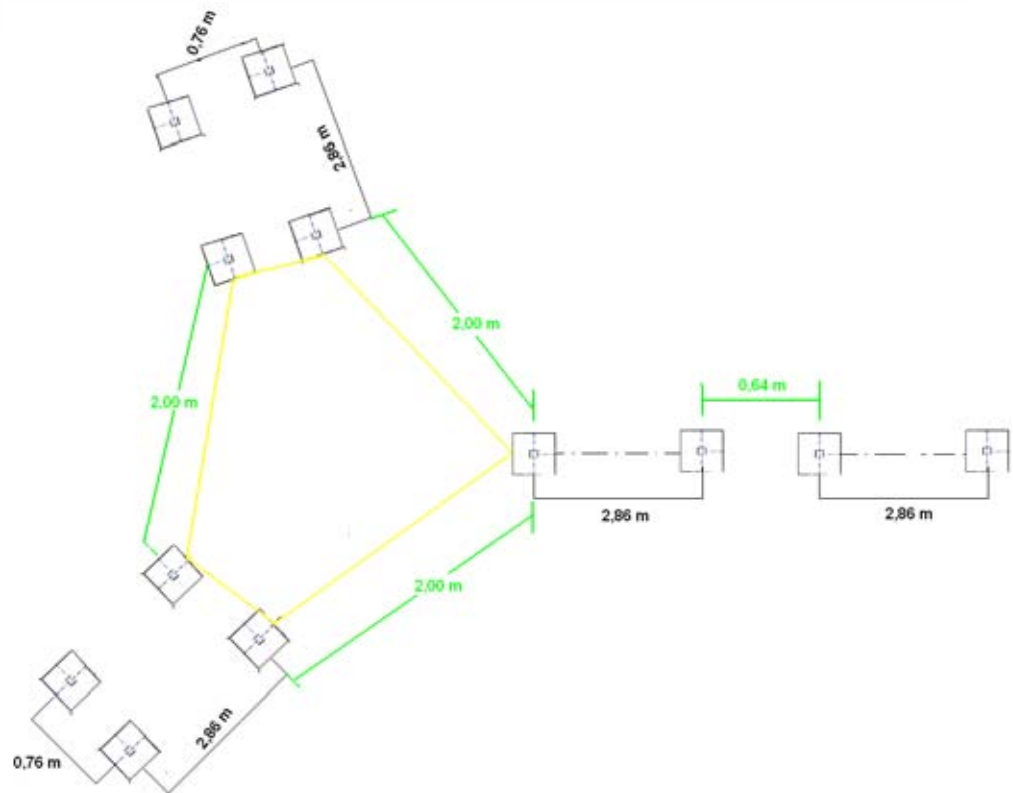
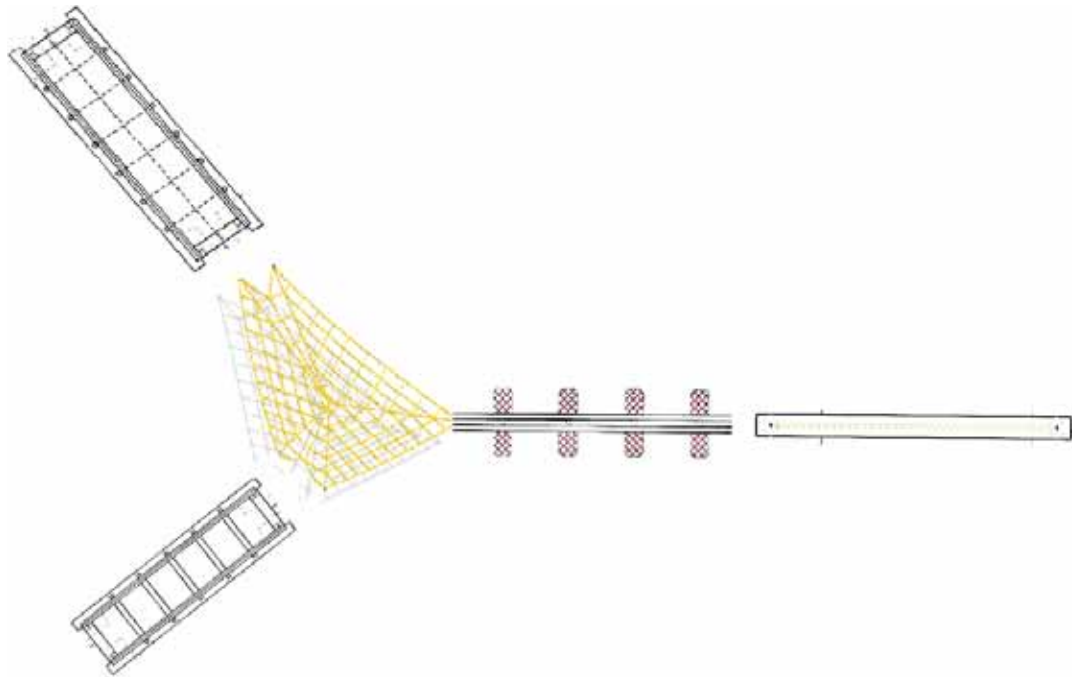

Installation Instructions

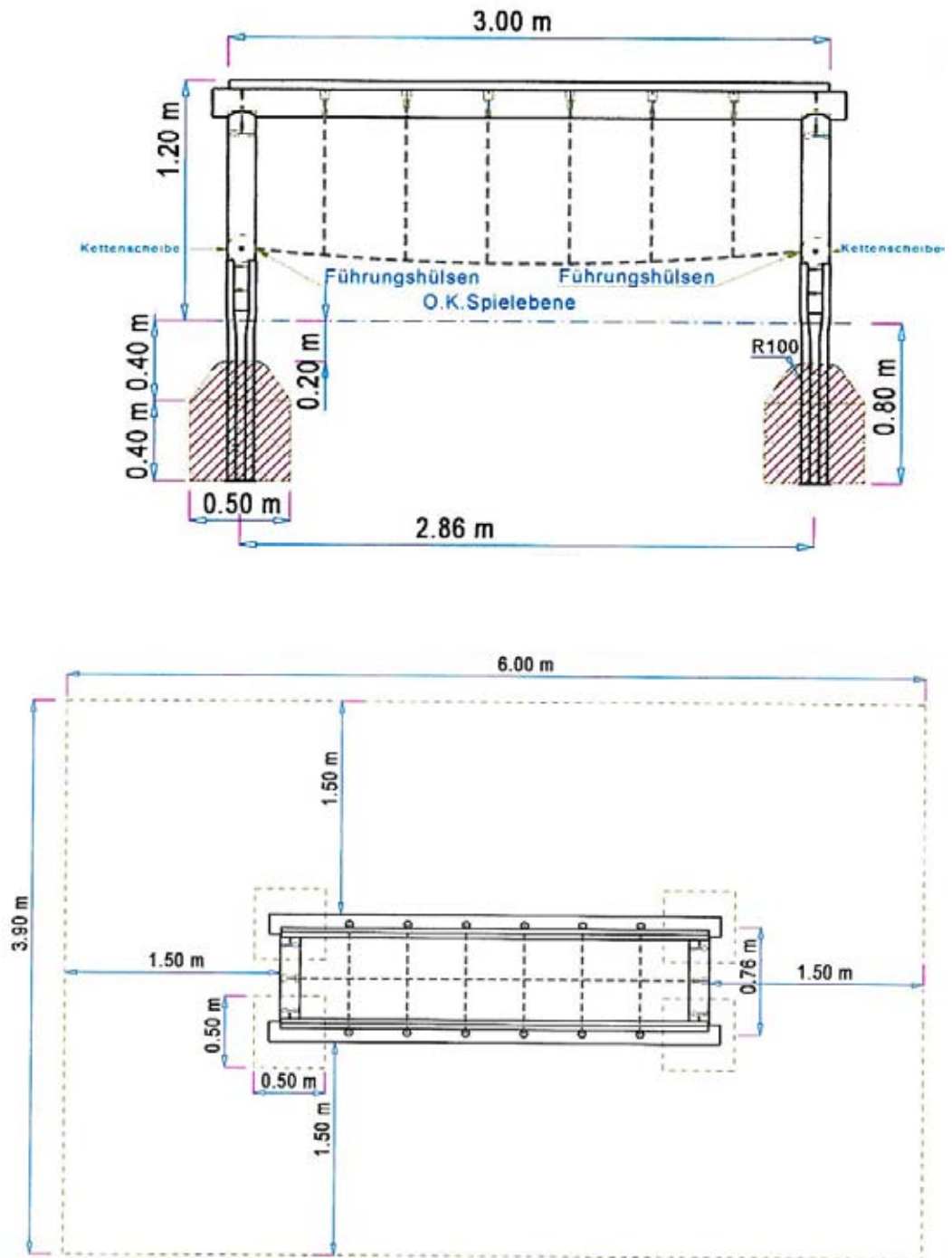

Installation Instructions

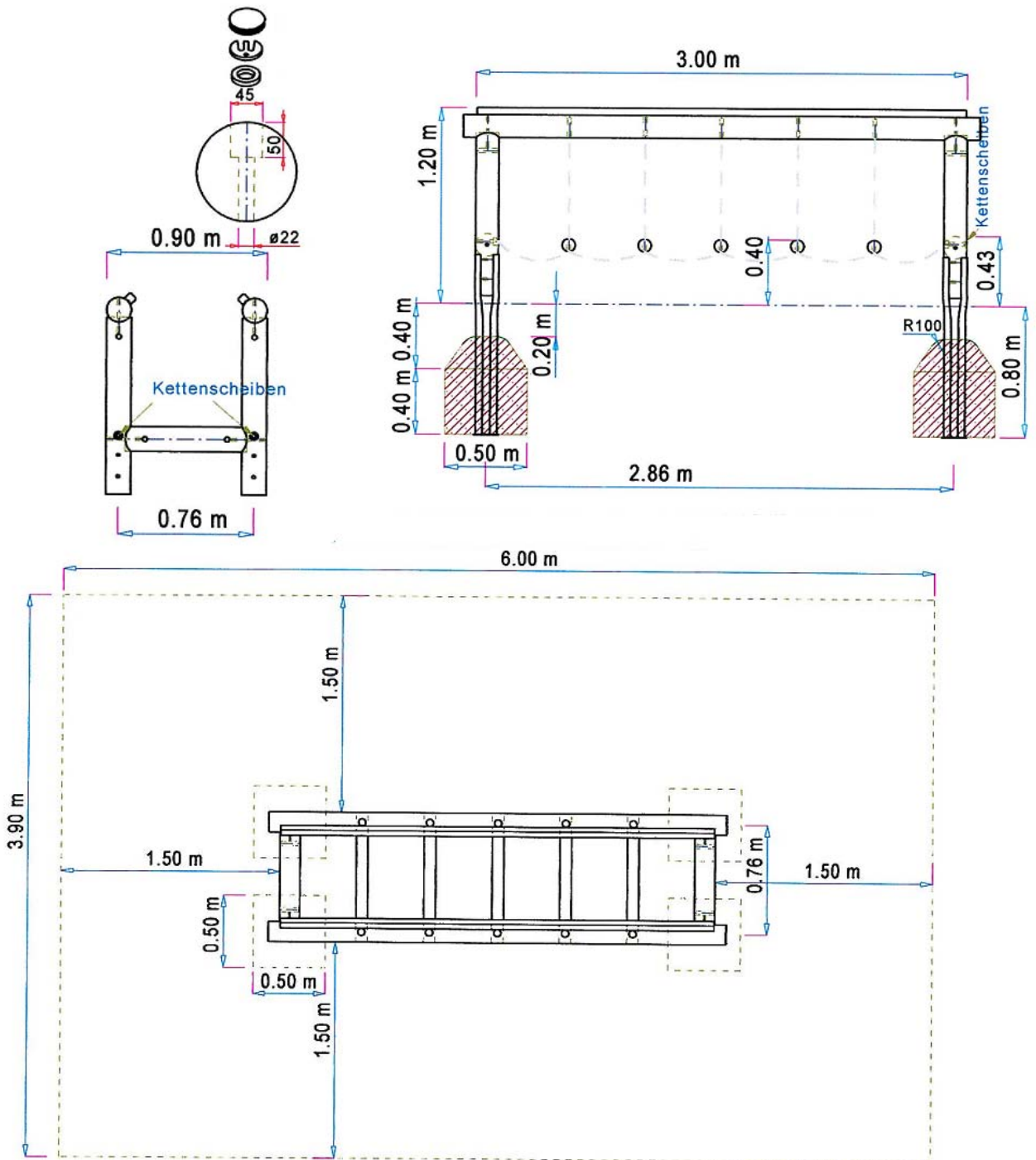

Installation Instructions

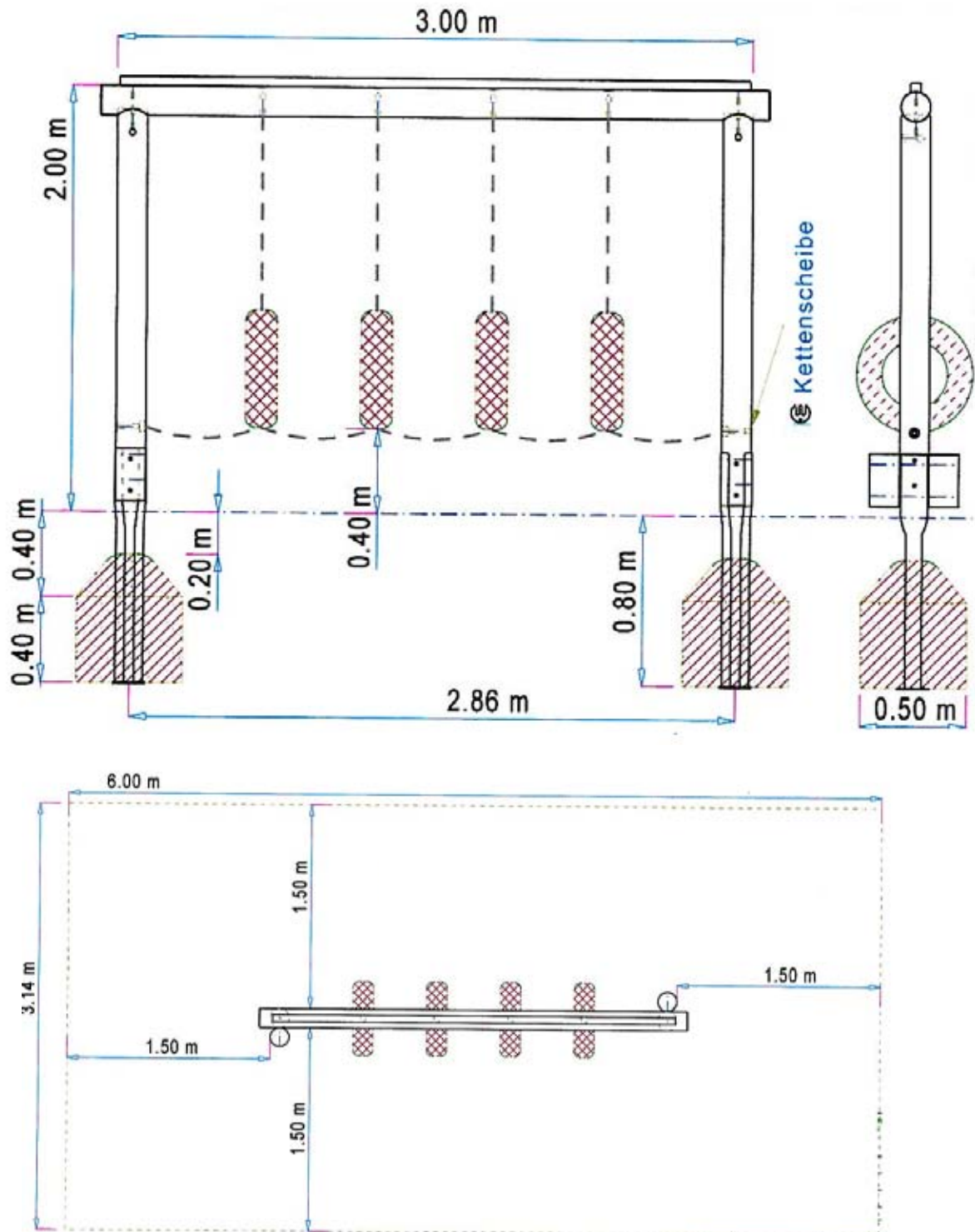

Installation Instructions

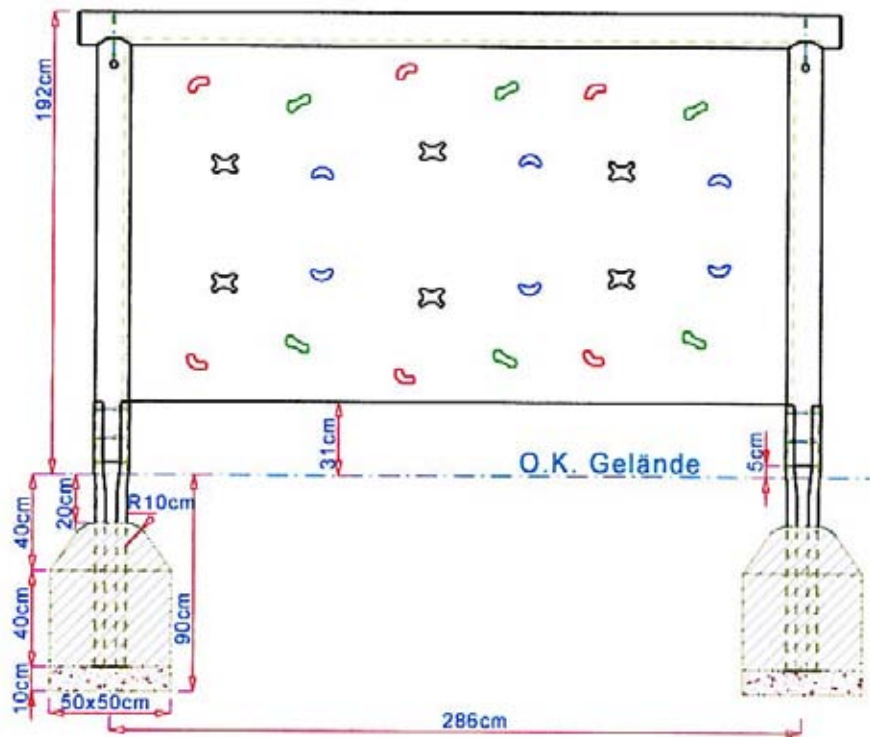
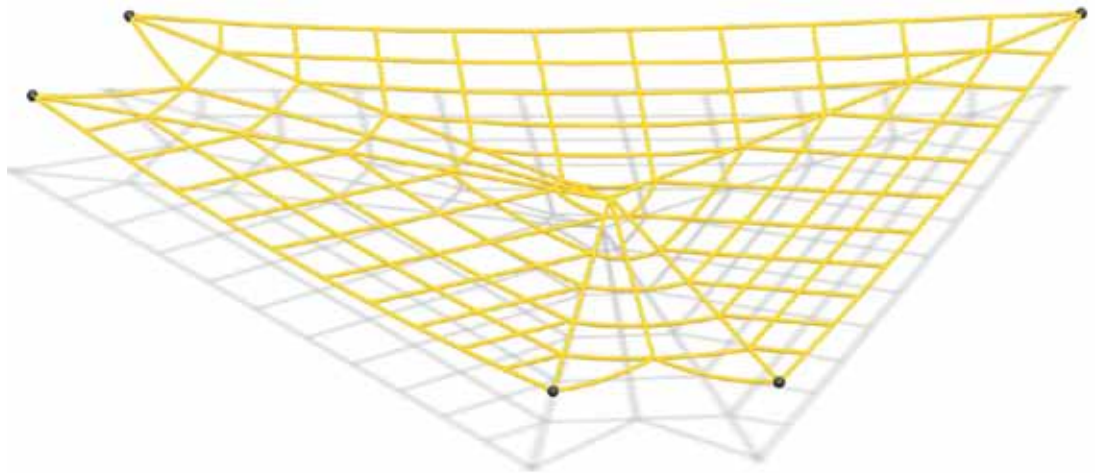

Installation Instructions

Foundation

The stated foundation is a standard for soil class 4.

At non-binding soil (e.g. sand, flint or humus) size of the foundation has to be adjusted.

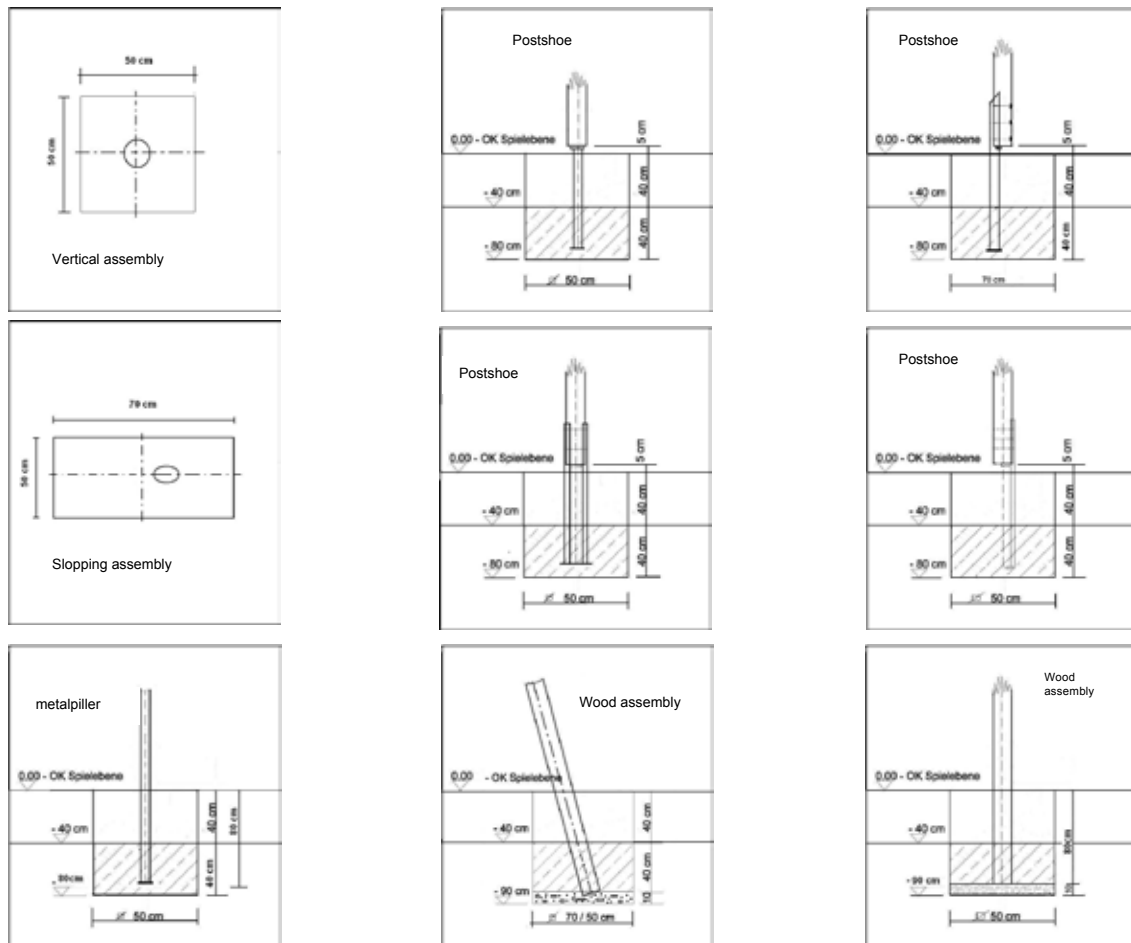

Legend

- 1 Pillar
- 2 ground level
- 3 foundation (C25/30)
- 4 Mark of the top of ground level
- 5 mark of the foundation

Products with just one stand wood or with a small Stableness, should be lay by these foundations.

Längenmaße in Millimetern

If you default the 10 cm drainage course (gravel packing) for wood assembly, we cannot assure the lives of the lumber.

Installation Instructions

ASSEMBLY INSTRUCTIONS

In order to allow for normal tolerances in manufacture, it is essential on all combined structures and multiplay units to assemble the complete structure (including bridges, chain links etc.) **before** the structure is concreted in. In order to guarantee that the foundations are fully set, the installer should ensure that the apparatus is not used for **at least five days**.

All bolt fittings should be fitted with locknuts. If these are not available, a secure method of fixing should be employed (e.g. threadlock or silicone).

All bolts and screws should be retightened 14 days after installing the apparatus.

Wooden components are a **natural product**, and there may be cracks in the grain; however the load carrying capacity of the timber is unaffected.

Net and rope fixings:

1. Apply locking compound to eyebolt thread and attach to turnbuckle body.
2. Insert the turnbuckle body into the hole in the post.
3. Apply locking compound to countersunk screw, fit to other end of turnbuckle body with washer, and tighten.

Check the dimensions of the apparatus before assembling.

No liability is accepted in the case of incorrectly installed product.

Please see below details of safety surface guidelines according to EN1176

Table A.1 shows various materials and their respective fall heights, because of variability in materials, the table can only provide approximations with regard to playground surfaces. Frozen conditions are not taken into account.

Table A.1: Commonly used shock absorbing materials and their respective critical fall heights

Material ¹	Description mm	Minimum Depth ² mm	Max. Fall Height mm
Grass / Topsoil			≤ 1 000
Bark	20 to 80 granulation	300	≤ 3 000
Wood-chips	5 to 30 granulation		
Sand ³	0,2 to 2 granulation		
Gravel	2 to 8 granulation		
Other materials	Corresponding to HIC test		Critical fall height as per test

¹) suitably prepared materials for use on playgrounds
²) see notes in clause 4.1.3 of EN1176
³) clay-free

Table D.1: Types of surfacing and their permissible free fall heights

Type	Material	Description	Minimum Depth mm	Max. Fall Height mm
1	Concrete / Stone			≤ 600
2	Tarmac			≤ 600
3	Topsoil			≤ 1 000
4	Earth			≤ 1 000
5	Grass			≤ 1 000
6	Wood-chips	Mechanically cut wood (not MDF or similar), without bark and leaves, granulation 5 mm to 30 mm	300	≤ 3 000
7	Bark	Cut bark of coniferous trees, granulation 20 mm to 80 mm	300	≤ 3 000
8	Sand	No clay content, washed, granulation 0,2 mm to 2 mm	300	≤ 3 000
9	Gravel	Round and washed, granulation 2mm to 8 mm	300	≤ 3 000
10	Synthetic Safety Surfacing	With HIC test		≤ 3 000

Maintenance

MAINTENANCE GUIDELINES for sports, playground and leisure equipment according to EN1176-7

Recommendation for periodic maintenance:

w = weekly, m = month, y = year

	w	1-3 m	½ - y
1. Visual inspection of the articles for damage, of the surfacing and slides for sharp objects and for any exposed foundations.	<input checked="" type="checkbox"/>	<input type="checkbox"/>	<input type="checkbox"/>
2. Check all fixings and metal fittings for wear, tear and tightness; tighten if required. Replace damaged parts.	<input type="checkbox"/>	<input checked="" type="checkbox"/>	<input type="checkbox"/>
3. Check all moving metal parts (links, springs etc.) for smooth operation and wear and tear, change if required. It is not necessary to grease links (e.g. swing hangers) as only maintenance-free hangers are employed.	<input type="checkbox"/>	<input checked="" type="checkbox"/>	<input type="checkbox"/>
4. Check all accessories such as chains, ropes, nets etc. for damage and change if required.	<input type="checkbox"/>	<input checked="" type="checkbox"/>	<input type="checkbox"/>
5. Check all rubber parts, sleeves etc. for wear and tear and change if required.	<input type="checkbox"/>	<input checked="" type="checkbox"/>	<input type="checkbox"/>
6. Check cableway mechanism, seats and brake springs for correct operation and wear and tear, change if required. Check the tension and the sag of the cable and adjust as needed.	<input type="checkbox"/>	<input checked="" type="checkbox"/>	<input type="checkbox"/>
7. Check the surface of plastic and metal parts, e.g. at slides, for damage and change if needed.	<input type="checkbox"/>	<input checked="" type="checkbox"/>	<input type="checkbox"/>
8. Check and repair the surface of wooden parts for damages caused by weather or other causes, replace if required.	<input type="checkbox"/>	<input type="checkbox"/>	<input checked="" type="checkbox"/>
9. Check stability (stands, struts, foundations etc.), as required, if necessary by exposing/ digging up of certain parts.	<input type="checkbox"/>	<input type="checkbox"/>	<input checked="" type="checkbox"/>

The checks and maintenance should be executed in the periods stated by competent personnel.

Through play, weathering and also vandalism, wear and tear is possible, which may reduce safety and function.

For safety related defects it is necessary to take prompt action, either by immediate repair or by dismantling or isolating the equipment.

Defects which impair the operation, reduce the play value of the equipment, induce vandalism, or jeopardise safety, need to be attended to immediately.

Maintenance and repair is to be executed by competent personnel only.

Maintenance

Order No.: _____

Location: _____

Customer: _____

Name of project: _____

- is the safety zone and the foundation according to the installation instruction?

yes no

- are there any obvious defects on the product, which cannot be repaired by the assembler? yes no

- are all transport parts and utilities removed? yes no

- is place ready for play? yes no following things are to do

Place/ Date: _____

Signature Customer: _____ Signature Contractor: _____